

THIS DRAWING IS UNPUBLISHED.

RELEASED FOR PUBLICATION

© COPYRIGHT - By -

ALL RIGHTS RESERVED.

LOC FT DIST 0

REVISIONS

P	LTR	DESCRIPTION	DATE	DWN	APVD
	A	REVISED PER ECO-11-023039	18FEB12	KH	MS

MATERIAL:
 HOUSING: NYLON, UL94V-0, BLACK.
 TERMINALS: BRASS, BRIGHT TIN PLATED.
 SCREWS: 6-32, STEEL, ZINC CHROMATE FINISH
 UNLESS OTHERWISE NOTED.

ELECTRICAL:
 MAXIMUM CURRENT: 20A
 OPERATING VOLTAGE: 600V
 WIRE RANGE: 12-22 AWG

ENVIRONMENT:
 OPERATING TEMP.: -60°C TO 105°C

1 ALL SCREWS BOTTOMED, TORQUE 2 TO 4 IN-LBS

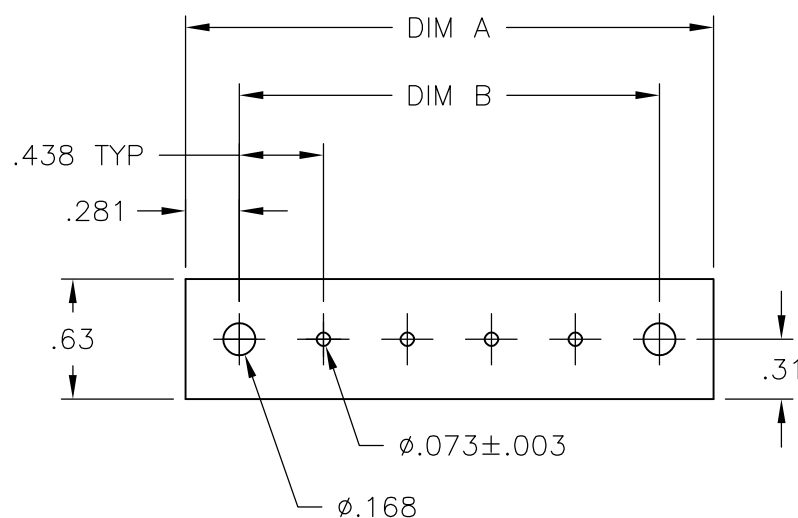
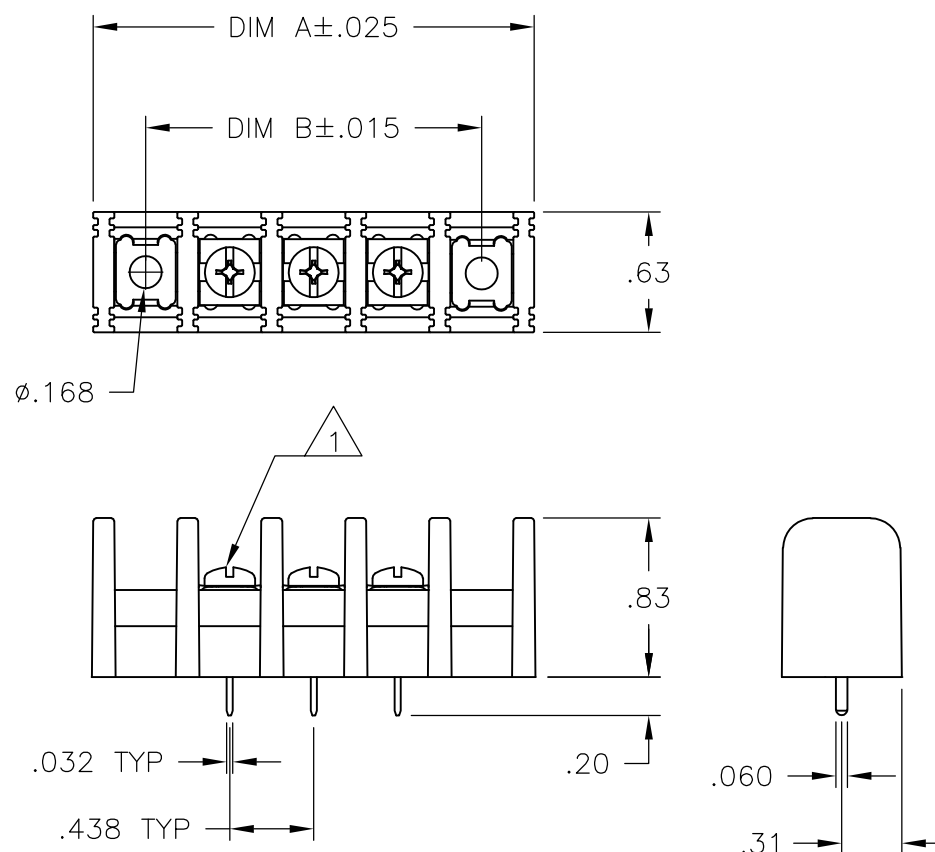

RECOMMENDED PCB LAYOUT

DIM B	DIM A	NO. OF POS.	CATALOG NUMBER	PART NUMBER
11.375	11.937	25	SSB7FE250201	-
10.937	11.500	24	SSB7FE240201	-
10.500	11.062	23	SSB7FE230201	-
10.062	10.625	22	SSB7FE220201	-
9.625	10.187	21	SSB7FE210201	-
9.187	9.750	20	SSB7FE200201	-
8.750	9.312	19	SSB7FE190201	-
8.312	8.875	18	SSB7FE180201	-
7.875	8.437	17	SSB7FE170201	-
7.437	8.000	16	SSB7FE160201	-
7.000	7.562	15	SSB7FE150201	-
6.562	7.125	14	SSB7FE140201	-
6.125	6.687	13	SSB7FE130201	-
5.687	6.250	12	SSB7FE120201	-
5.250	5.812	11	SSB7FE110201	-
4.812	5.375	10	SSB7FE100201	-
4.375	4.937	9	SSB7FE090201	-
3.937	4.500	8	SSB7FE080201	-
3.500	4.062	7	SSB7FE070201	-
3.062	3.625	6	SSB7FE060201	1986396-6
2.625	3.187	5	SSB7FE050201	-
2.187	2.750	4	SSB7FE040201	-
1.750	2.312	3	SSB7FE030201	-
1.312	1.875	2	SSB7FE020201	-
.875	1.437	1	SSB7FE010201	-

THIS DRAWING IS A CONTROLLED DOCUMENT.

DWN S SCHL GEL 3/17/08
 CHK C WARNER 3/17/08
 APVD C WARNER 3/17/08

TE Connectivity

SSB7FEXX0201

PRODUCT SPEC
 APPLICATION SPEC

SIZE A3 CAGE CODE 00779 DRAWING NO C-1986396 RESTRICTED TO -

WEIGHT -

CUSTOMER DRAWING SCALE NTS SHEET 1 OF 1 REV A

DIMENSIONS: INCHES	TOLERANCES UNLESS OTHERWISE SPECIFIED:
0 PLC	± -
1 PLC	± -
2 PLC	± .02
3 PLC	± .010
4 PLC	± -
ANGLES	± 1°

MATERIAL - FINISH -