

MATERIALS AND FINISHES:

BODY, OUTER CONTACT, CRIMP TUBE: BRASS  
PLATED: GOLD

CENTER CONTACT: BERYLLIUM COPPER  
PLATED: GOLD

RETAINING RING: BERYLLIUM COPPER  
PLATED: NICKEL

INSULATOR: TEFLON

CRIMP DIE: 3.25(.128) HEX

CONTACT SHALL MATE WITH  
0.36/0.41  
Ø .014/.016  
MALE CONTACT

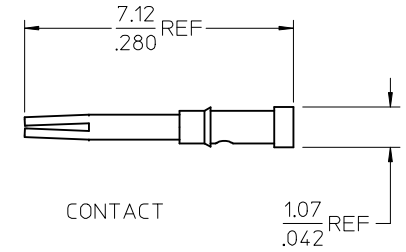
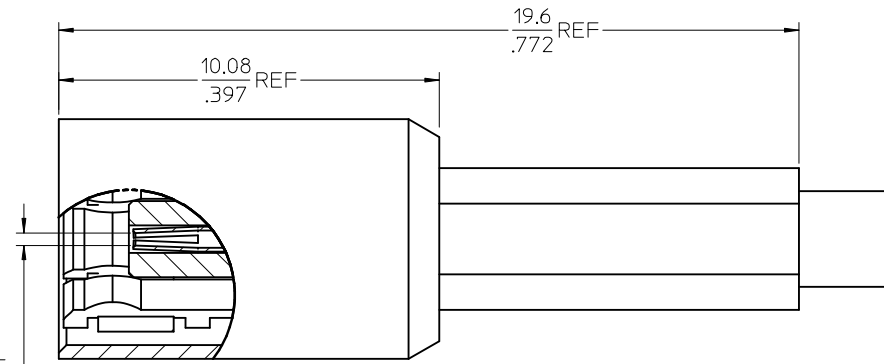

CONTACT

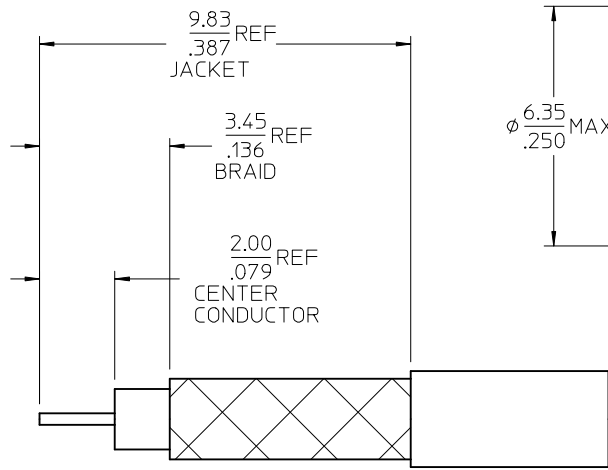

CABLE STRIP DIMENSIONS

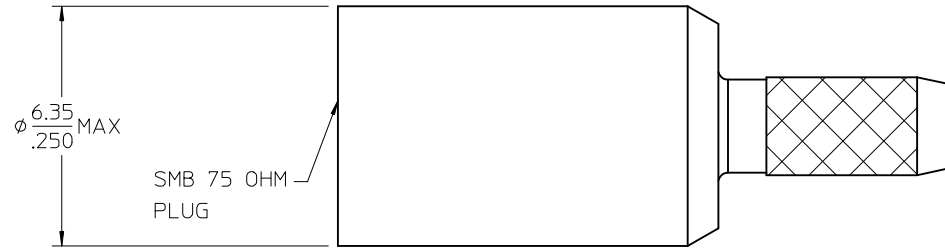

SMB 75 OHM  
PLUG

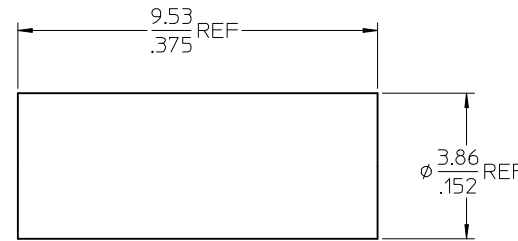

CRIMP TUBE

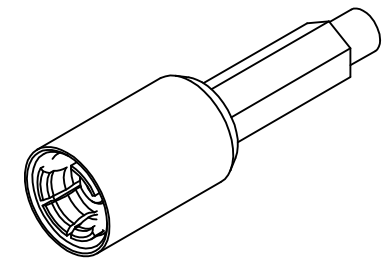

PART # 73404-1600

CHG: NEW FRAME  
DELETE VIEW  
.136 WAS .126  
.387 WAS .362

EC NO: URF2009-0688  
DRWN: WIENER 2009/05/27  
CHKD: SHAH 2009/05/27  
APPR: WIENER 2009/05/27

DESCRIPTION

QUALITY SYMBOLS  
▽=0  
▽=0

GENERAL TOLERANCES (UNLESS SPECIFIED)

	DIMENSION STYLE	
	mm	INCH
4 PLACES	± .005	± .0005
3 PLACES	± .005	± .0005
2 PLACES	± .005	± .0005
1 PLACE	± .005	± .0005
ANGULAR ±1/2°		

DRAFT WHERE APPLICABLE  
MUST REMAIN  
WITHIN DIMENSIONS

DRAWN BY DATE

SSS

CHECKED BY DATE

TEF 2004/03/10

APPROVED BY DATE

GMH 2004/03/10

MATERIAL NO.  
SIZE C

DIMENSION STYLE

IN/MM

SEE TABLE

THIS DRAWING CONTAINS INFORMATION THAT IS PROPRIETARY TO MOLEX INCORPORATED AND SHOULD NOT BE USED WITHOUT WRITTEN PERMISSION

SCALE

DESIGN UNITS

INCH

THIRD ANGLE PROJECTION

TITLE

DOCUMENT NO.

SMB PLUG STR RG179

75 OHM

SMB-PC EWR-2369

MOLEX INCORPORATED

SD-73404-160

SHEET NO. 1 OF 1